

**STRAIGHT BULKHEAD JACK CLAMP TYPE  
REAR MOUNT - CABLE 3/8" HELICAL**

**R185.317.200**  
**SERIES 7-16**

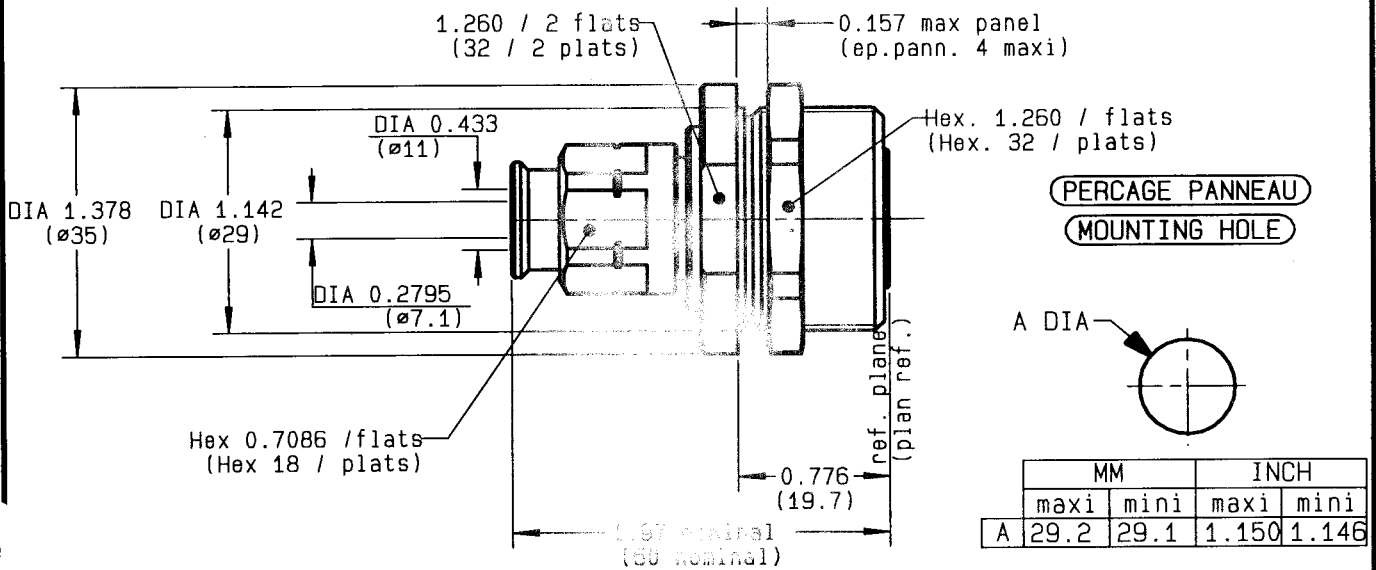

NOMINAL IMPEDANCE	<b>50</b>	Ω
FREQUENCY RANGE	<b>0-7.5</b>	GHz
TEMPERATURE RATING	<b>-55/+155</b>	°C
V.S.W.R	<b>1.20 +</b>	0 x F (GHz) Maxi
RF INSERTION LOSS	<b>0.05</b>	√F (GHz) dB Maxi
VOLTAGE RATING	<b>1400</b>	Veff Maxi
DIELECTRIC WITHSTANDING VOLTAGE	<b>2700</b>	Veff Mini
INSULATION RESISTANCE	<b>10000</b>	MΩMini
HERMETIC SEAL	<b>NA</b>	Atm.cm <sup>3/2</sup>
LEAKAGE (pressurized only)	<b>IP 67</b>	
MECHANICAL DURABILITY	<b>500</b>	Cycles
WEIGHT	<b>138.1</b>	gr
SPECIFICATION		

CABLES : **FSJ2-50-3/8" HELIAx**  
**HCF 3/8" Cu2Y AlCu**  
**HCF 3/8" CuH**

OTHERS CHARACTERISTICS

ROs	<b>1.10</b>	a 3 GHz
CABLE RETENTION	<b>270</b>	N Mini
CENTER CONTACT RETENTION		
Axial force - mating end	<b>200</b>	N Mini
Axial force - opposite end	<b>100</b>	N Mini
Torque	<b>2</b>	cm.N Mini
RECOMMENDED TORQUES		
Mating	<b>3500</b>	cm.N
Panel nut	<b>3000</b>	cm.N
Clamp nut	<b>950</b>	cm.N

CONNECTOR PARTS:	MATERIALS	FINISH	(all values are given in micrometers)
BODY	BRASS	BBR 0.5 OVER SILVER 3	
OUTER CONTACT	BRASS	SILVER 5 OVER COPPER 0.5	
CENTER CONTACT	BERYLLIUM COPPER	SILVER 5 OVER COPPER 0.5	
INSULATOR	PTFE	-	
GASKET	SILICONE RUBBER	-	
OTHERS PIECES	BRASS	BBR 2	

ISSUE	CREATION DATE	FILE PART-NUMBER
<b>9949A00</b>	<b>05/05/1999</b>	<b>EPC96-02</b>



The information given here is subject to change without notice.  
Design changes may be in order to improve the product.

*Connect to the future*



**RADIALL**<sup>®</sup>

**R185.317.200**

ISSUE 9949A00 SERIES

7-16

HEATSHRINK SLEEVE

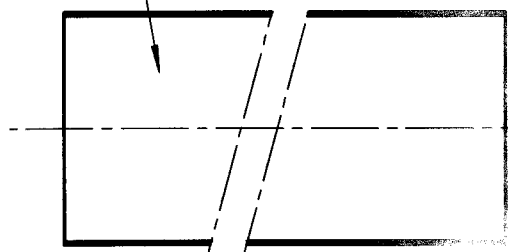

BRAID CLAMP NUT

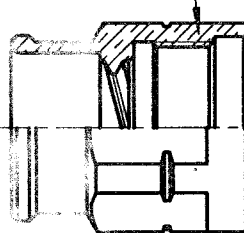

GASKET

BODY

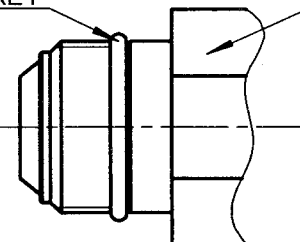

- ①
- Strip the cable.  
Stripping tool R282.010.040
  - Do not damage the outer conductor.
  - Deburr cable inner conductor.

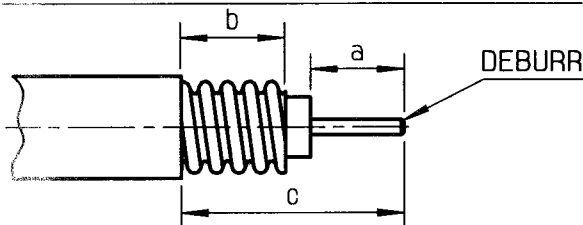

Stripping	a	b	c	d	e
inch	0.217	0.197	0.453	0	0
mm	5.5	5	11.5		

- ②
- Slide the heatshrink sleeve onto the cable.
  - Screw manually the braid clamp nut onto cable outer conductor until stop.

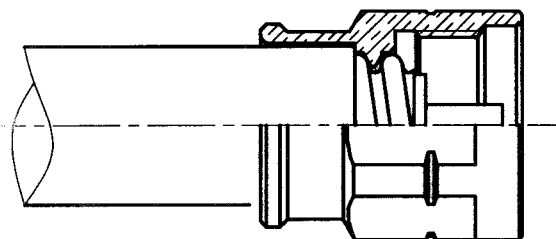

- ③
- Screw the connector onto the assembly.
- WARNING : Screw the connector on the braided clamp nut turning left (lefthand thread) so that the copper outer conductor is being squeezed.

Torque wrench R282.303.220  
Recommended coupling torque: 84.07 (6.03)  
950 Ncm

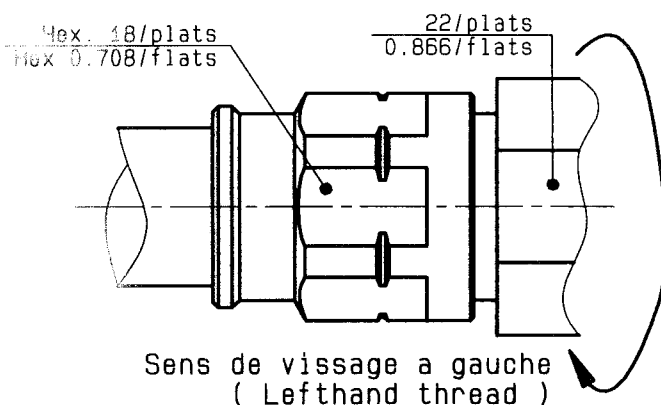

- ④
- Shrink the heatshrink sleeve.

Shrink the heatshrink sleeve

